

**PROPOSAL AND CONTRACT
(WHEN EXECUTED)**

INSTRUCTIONS ON PAGE 4

**THIS PROPOSAL INCLUDES
INSTRUCTIONS TO BIDDERS**
A. DEPOSIT OF PROPOSALS.

All envelopes containing Bid proposals shall
be clearly marked "Bid Proposal for letting of
September 8, 2025."

DATE

WEST SADSURY TOWNSHIP - QUARRY RD
MUNICIPALITY (NAME & TYPE)

Chelsy Oswald
SECRETARY

Sealed Proposals will be received on or before
1:00 PM on the above Letting Date.
TIME

6400 N. Moscow Road
Parkesburg, PA 19365
ADDRESS

Bids will be opened and read at approximately
1:00 PM, on the above Letting Date.
TIME

PROPOSALS MUST BE MAILED OR OTHERWISE
DELIVERED TO THE ABOVE ADDRESS.

- 1 The contractor proposes to furnish and deliver all materials (including Form CS-4171, CERTIFICATE OF COMPLIANCE and/ or CS-4171B DAILY ASPHALT MIXTURE CERTIFICATION) and to do and perform all work on the following project as more specifically set forth in the Schedule of Prices (Attachment), in accordance with drawings and specifications on file at _____ as well as the supplements and special requirements contained herein and/ or attached hereto and current PennDOT Specifications (Publication 408), except (a) bidders need not be prequalified by PennDOT (Sec.102.01), and (b) Volumetric testing of asphalt paving materials is not required (Sec. 413).
- 2 If designated as the successful bidder, the contractor will begin work on the date specified in the notice to proceed, or as otherwise provided in the special requirements, and will complete all work within **see attachment 1-A** calendar days.
- 3 Accompanying this proposal is a certified check or bid bond in the amount of **10% of Highest Alternate** made payable to the municipality as a proposal guarantee which, it is understood, will be forfeited in case the contractor fails to comply with the requirements of the proposal.

B. PROPOSAL OF:

NAME / ADDRESS OF CONTRACTOR
CONTRACTORS CERTIFICATION
It is hereby certified as follows:

- 1 The only person interested in the proposal as principal (s) is (are):

- 2 None of the above persons are employees of the municipality.
- 3 This proposal is made without collusion with any other person, firm or corporation.
- 4 All plans and specifications referred to above and the site of the work have been examined by the contractor. The contractor understands that the quantities indicated herein are approximate and are subject to change as may be required; and that all work is payable on the basis of the unit price listed on the Schedule of Prices. (Attachment 1).

- 5 The contractor will comply with all requirements of the laws and implementing regulations of the Commonwealth of Pennsylvania and the United States relating to human relations, equal opportunity and non-discrimination in employment, and will pay to workmen employed in the performance of the contract the wages to which they may be entitled.
- 6 The contractor will provide the municipality with a performance bond, conditioned upon the faithful performance of the contract in accordance with the plans, specifications and conditions thereof, and a payment bond, conditioned on the prompt payment of all material furnished and labor supplied or performed in the prosecution of the work, in accordance with the Public Works Contractors' Bond Law of 1967; and an affidavit accepting the provisions of the Workmen's Compensation Act of 1915, as amended.

CONTRACTOR

BY: _____ DATE: _____
TITLE: _____

WITNESSED OR ATTESTED BY: _____ DATE: _____
TITLE: _____

TO BE EXECUTED ONLY IN THE EVENT THE ABOVE PROPOSAL IS ACCEPTED

ACCEPTED ON : September 9, 2025
DATE

WEST SADBURY TOWNSHIP
MUNICIPALITY

BY: _____
TITLE: BOS CHAIRMAN

BY: _____
TITLE: BOS VICE-CHAIRMAN

BY: _____
TITLE: BOS MEMBER

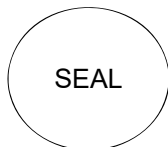

ATTESTED BY: _____
TITLE: TOWNSHIP SECRETARY

ATTACHMENT 1.1

TO MS - 944 (PROPOSAL AND CONTRACT MS - 944)

County: CHESTER

Municipality: WEST SADSURY TOWNSHIP

Project Number:

LOCATION OF WORK:

QUARRY ROAD (T-413), FROM STA 0+00 AT SR 10 ROW, FULL WIDTH, TO STA 55+67 NEAR TOWNSHIP LINE

DESCRIPTION OF WORK:

THERE ARE FIVE (5) DIFFERENT ALTERNATIVES FOR THE TOWNSHIP TO CHOOSE FROM. THE TOWNSHIP RESERVES THE RIGHT TO CHOOSE ANY ONE (1) OF THE FIVE (5) ALTERNATES AT THEIR DISCRETION. THE ALTERNATES GENERALLY INCLUDE:

1) ROADWAY RESTORATION, 1.5" OVERLAY & INSTALLATION OF PAVING FABRIC

2) ROADWAY RESTORATION & 1.5" OVERLAY

3) 1.5" MILL, OVERLAY & INSTALLATION OF PAVING FABRIC

4) 1.5" MILL & OVERLAY

5) 3" MILL AND OVERLAY WITH 25 MM SUPERPAVE & OVERLAY WITH 1.5" - 9.5 MM SUPERPAVE

*CONTRACTOR IN CHARGE OF ALL PURCHASE, TRANSPORT, AND INSTALLATION OF MATERIALS IN ACCORDANCE WITH PENNDOT PUB 408 SPECIFICATIONS

ESCALATOR CLAUSE:(if adopted by Municipality.)

NONE

THIS PORTION TO BE COMPLETED
BY THE MUNICIPALITY

SCHEDULE OF PRICES

Item 1 No.	Approximate 2 Quantities	Unit 3	*Description 4	Unit 5 Price	Total 6
1	100	SY	Full-Depth (11.5") Base Repair & Road Restoration, including excavation, removal of materials and transport, installation of 6" of 2A aggregate and installation of 5.5" - 25 mm SUPERPAVE to top of existing surface. (Complete in place)		
2	2,480	LF	Mill and Overlay, 3" Depth, 7' Wide, to top of existing surface, including removal and transport of existing materials, tack coat and Installation of 3" - 25 mm SUPERPAVE. (Complete in place)		
3	3,340	LF	Mill and Overlay, 3" Depth, Full Lane Width (+/- 10'), to top of existing surface, including removal and transport of existing materials, tack coat and Installation of 3" - 25 mm SUPERPAVE. (Complete in place)		
4	733	SY	Mill Notch, 1.5" Depth, Varying Width, including removal of existing materials and transport. (Complete in place)		
5	50	TON	Installation of 1" Minimum depth 9.5 mm SUPERPAVE Scratch/Leveling Course. (Complete in place)		
6	1,115	TON	Clean Roadway Surface and Installation of 1.5" of 9.5 mm SUPERPAVE with tack coat and pavement joint sealing over existing varying roadway width; +/- 20' wide. Pave with safety edges. (Complete in place)		
7	10,430	SY	Installation of PennDOT Approved Paving Fabric full length and width of roadway. (Complete in place)		

* DESCRIPTION:

Must include ADT on wearing surfaces
USE OF CUTBACK ASPHALT IS PROHIBITED
BETWEEN MAY 1st AND OCTOBER 31st, EXCEPT
AS NOTED IN BULLETIN NO. 25.
FOR OPTION OR PHASE BIDS THE TOTALS FOR
EACH MUST BE INCLUDED.

ALTERNATIVE NO. 1

SUBTOTAL	
SUBTOTAL FROM OTHER ATTACHMENTS	
BID TOTAL FOR A NON OPTION / PHASE BID	
OPTION 1 OR PHASE 1 BID TOTAL	
OPTION 2 OR PHASE 2 BID TOTAL	
OPTION 3 OR PHASE 3 BID TOTAL	

**ATTACHMENT 1.2****TO MS - 944 (PROPOSAL AND CONTRACT MS - 944)**County: CHESTER

Municipality: _____

WEST SADSBUURY TOWNSHIP

Project Number: _____

LOCATION OF WORK:

QUARRY ROAD (T-413), FROM STA 0+00 AT SR 10 ROW, FULL WIDTH, TO STA 55+67 NEAR TOWNSHIP LINE

DESCRIPTION OF WORK:

THERE ARE FIVE (5) DIFFERENT ALTERNATIVES FOR THE TOWNSHIP TO CHOOSE FROM. THE TOWNSHIP RESERVES THE RIGHT TO CHOOSE ANY ONE (1) OF THE FIVE (5) ALTERNATES AT THEIR DISCRETION. THE ALTERNATES GENERALLY INCLUDE:

1) ROADWAY RESTORATION, 1.5" OVERLAY & INSTALLATION OF PAVING FABRIC

2) ROADWAY RESTORATION & 1.5" OVERLAY

3) 1.5" MILL, OVERLAY & INSTALLATION OF PAVING FABRIC

4) 1.5" MILL & OVERLAY

5) 3" MILL AND OVERLAY WITH 25 MM SUPERPAVE & OVERLAY WITH 1.5" - 9.5 MM SUPERPAVE

*CONTRACTOR IN CHARGE OF ALL PURCHASE, TRANSPORT, AND INSTALLATION OF MATERIALS IN ACCORDANCE WITH PENNDOT PUB 408 SPECIFICATIONS

ESCALATOR CLAUSE:(if adopted by Municipality.)

NONE

THIS PORTION TO BE COMPLETED
BY THE MUNICIPALITY**SCHEDULE OF PRICES**

Item 1 No.	Approximate 2 Quantities	Unit 3	*Description 4	Unit 5 Price	Total 6
1	100	SY	Full-Depth (11.5") Base Repair & Road Restoration, including excavation, removal of materials and transport, installation of 6" of 2A aggregate and installation of 5.5" - 25 mm SUPERPAVE to top of existing surface. (Complete in place)		
2	2,480	LF	Mill and Overlay, 3" Depth, 7' Wide, to top of existing surface, including removal and transport of existing materials, tack coat and Installation of 3" - 25 mm SUPERPAVE. (Complete in place)		
3	3,340	LF	Mill and Overlay, 3" Depth, Full Lane Width (+/- 10'), to top of existing surface, including removal and transport of existing materials, tack coat and Installation of 3" - 25 mm SUPERPAVE. (Complete in place)		
4	733	SY	Mill Notch, 1.5" Depth, Varying Width, including removal of existing materials and transport. (Complete in place)		
5	50	TON	Installation of 1" Minimum depth 9.5 mm SUPERPAVE Scratch/Leveling Course. (Complete in place)		
6	1,115	TON	Clean Roadway Surface and Installation of 1.5" of 9.5 mm SUPERPAVE with tack coat and pavement joint sealing over existing varying roadway width; +/- 20' wide. Pave with safety edges. (Complete in place)		

*** DESCRIPTION:**

Must include ADT on wearing surfaces

USE OF CUTBACK ASPHALT IS PROHIBITED

BETWEEN MAY 1st AND OCTOBER 31st, EXCEPT AS NOTED IN BULLETIN NO. 25.

FOR OPTION OR PHASE BIDS THE TOTALS FOR EACH MUST BE INCLUDED.

ALTERNATIVE NO. 2

SUBTOTAL

SUBTOTAL FROM OTHER ATTACHMENTS	
BID TOTAL FOR A NON OPTION / PHASE BID	
OPTION 1 OR PHASE 1 BID TOTAL	
OPTION 2 OR PHASE 2 BID TOTAL	
OPTION 3 OR PHASE 3 BID TOTAL	

**ATTACHMENT 1.3****TO MS - 944 (PROPOSAL AND CONTRACT MS - 944)**County: CHESTER

Municipality: _____

WEST SADSBUURY TOWNSHIP

Project Number: _____

LOCATION OF WORK:

QUARRY ROAD (T-413), FROM STA 0+00 AT SR 10 ROW, FULL WIDTH, TO STA 55+67 NEAR TOWNSHIP LINE

DESCRIPTION OF WORK:

THERE ARE FIVE (5) DIFFERENT ALTERNATIVES FOR THE TOWNSHIP TO CHOOSE FROM. THE TOWNSHIP RESERVES THE RIGHT TO CHOOSE ANY ONE (1) OF THE FIVE (5) ALTERNATES AT THEIR DISCRETION. THE ALTERNATES GENERALLY INCLUDE:

1) ROADWAY RESTORATION, 1.5" OVERLAY & INSTALLATION OF PAVING FABRIC

2) ROADWAY RESTORATION & 1.5" OVERLAY

3) 1.5" MILL, OVERLAY & INSTALLATION OF PAVING FABRIC

4) 1.5" MILL & OVERLAY

5) 3" MILL AND OVERLAY WITH 25 MM SUPERPAVE & OVERLAY WITH 1.5" - 9.5 MM SUPERPAVE

*CONTRACTOR IN CHARGE OF ALL PURCHASE, TRANSPORT, AND INSTALLATION OF MATERIALS IN ACCORDANCE WITH PENNDOT PUB 408 SPECIFICATIONS

ESCALATOR CLAUSE:(if adopted by Municipality.)

NONE

THIS PORTION TO BE COMPLETED
BY THE MUNICIPALITY**SCHEDULE OF PRICES**

Item 1 No.	Approximate 2 Quantities	Unit 3	*Description 4	Unit 5 Price	Total 6
1	100	SY	Full-Depth (11.5") Base Repair & Road Restoration, including excavation, removal of materials and transport, installation of 6" of 2A aggregate and installation of 5.5" - 25 mm SUPERPAVE to top of existing surface. (Complete in place)		
2	733	SY	Mill Notch, 1.5" Depth, Varying Width, including removal of existing materials and transport. (Complete in place)		
3	150	TON	Installation of 1" Minimum depth 9.5 mm SUPERPAVE Scratch/Leveling Course. (Complete in place)		
4	1,115	TON	Mill and Overlay 1.5" of 9.5 mm SUPERPAVE with tack coat and pavement joint sealing over existing varying roadway width; +/- 20' wide. Pave with safety edges. Clean surface before applying tack coat and paving. Includes all removal and transport of existing and proposed materials. (Complete in place)		
5	10,430	SY	Installation of PennDOT Approved Paving Fabric full length and width of roadway. (Complete in place)		

*** DESCRIPTION:**

Must include ADT on wearing surfaces

USE OF CUTBACK ASPHALT IS PROHIBITED

BETWEEN MAY 1st AND OCTOBER 31st, EXCEPT AS NOTED IN BULLETIN NO. 25.

FOR OPTION OR PHASE BIDS THE TOTALS FOR EACH MUST BE INCLUDED.

ALTERNATIVE NO. 3

SUBTOTAL

SUBTOTAL FROM OTHER ATTACHMENTS

BID TOTAL FOR A NON OPTION / PHASE BID

OPTION 1 OR PHASE 1 BID TOTAL

OPTION 2 OR PHASE 2 BID TOTAL

OPTION 3 OR PHASE 3 BID TOTAL

**ATTACHMENT 1.4****TO MS - 944 (PROPOSAL AND CONTRACT MS - 944)**County: CHESTER

Municipality: _____

WEST SADSBUURY TOWNSHIP

Project Number: _____

LOCATION OF WORK:

QUARRY ROAD (T-413), FROM STA 0+00 AT SR 10 ROW, FULL WIDTH, TO STA 55+67 NEAR TOWNSHIP LINE

DESCRIPTION OF WORK:

THERE ARE FIVE (5) DIFFERENT ALTERNATIVES FOR THE TOWNSHIP TO CHOOSE FROM. THE TOWNSHIP RESERVES THE RIGHT TO CHOOSE ANY ONE (1) OF THE FIVE (5) ALTERNATES AT THEIR DISCRETION. THE ALTERNATES GENERALLY INCLUDE:

1) ROADWAY RESTORATION, 1.5" OVERLAY & INSTALLATION OF PAVING FABRIC

2) ROADWAY RESTORATION & 1.5" OVERLAY

3) 1.5" MILL, OVERLAY & INSTALLATION OF PAVING FABRIC

4) 1.5" MILL & OVERLAY

5) 3" MILL AND OVERLAY WITH 25 MM SUPERPAVE & OVERLAY WITH 1.5" - 9.5 MM SUPERPAVE

*CONTRACTOR IN CHARGE OF ALL PURCHASE, TRANSPORT, AND INSTALLATION OF MATERIALS IN ACCORDANCE WITH PENNDOT PUB 408 SPECIFICATIONS

ESCALATOR CLAUSE:(if adopted by Municipality.)

NONE

THIS PORTION TO BE COMPLETED
BY THE MUNICIPALITY**SCHEDULE OF PRICES**

Item 1 No.	Approximate 2 Quantities	Unit 3	*Description 4	Unit 5 Price	Total 6
1	100	SY	Full-Depth (11.5") Base Repair & Road Restoration, including excavation, removal of materials and transport, installation of 6" of 2A aggregate and installation of 5.5" - 25 mm SUPERPAVE to top of existing surface. (Complete in place)		
2	733	SY	Mill Notch, 1.5" Depth, Varying Width, including removal of existing materials and transport. (Complete in place)		
3	150	TON	Installation of 1" Minimum depth 9.5 mm SUPERPAVE Scratch/Leveling Course. (Complete in place)		
4	1,115	TON	Mill and Overlay 1.5" of 9.5 mm SUPERPAVE with tack coat and pavement joint sealing over existing varying roadway width; +/- 20' wide. Pave with safety edges. Clean surface before applying tack coat and paving. Includes all removal and transport of existing and proposed materials. (Complete in place)		

*** DESCRIPTION:**

Must include ADT on wearing surfaces

USE OF CUTBACK ASPHALT IS PROHIBITED

BETWEEN MAY 1st AND OCTOBER 31st, EXCEPT
AS NOTED IN BULLETIN NO. 25.FOR OPTION OR PHASE BIDS THE TOTALS FOR
EACH MUST BE INCLUDED.**ALTERNATIVE NO. 4**

SUBTOTAL	
SUBTOTAL FROM OTHER ATTACHMENTS	
BID TOTAL FOR A NON OPTION / PHASE BID	
OPTION 1 OR PHASE 1 BID TOTAL	
OPTION 2 OR PHASE 2 BID TOTAL	
OPTION 3 OR PHASE 3 BID TOTAL	

**ATTACHMENT 1.5****TO MS - 944 (PROPOSAL AND CONTRACT MS - 944)**County: CHESTER

Municipality: _____

WEST SADSBUURY TOWNSHIP

Project Number: _____

LOCATION OF WORK:

QUARRY ROAD (T-413), FROM STA 0+00 AT SR 10 ROW, FULL WIDTH, TO STA 55+67 NEAR TOWNSHIP LINE

DESCRIPTION OF WORK:

THERE ARE FIVE (5) DIFFERENT ALTERNATIVES FOR THE TOWNSHIP TO CHOOSE FROM. THE TOWNSHIP RESERVES THE RIGHT TO CHOOSE ANY ONE (1) OF THE FIVE (5) ALTERNATES AT THEIR DISCRETION. THE ALTERNATES GENERALLY INCLUDE:

1) ROADWAY RESTORATION, 1.5" OVERLAY & INSTALLATION OF PAVING FABRIC

2) ROADWAY RESTORATION & 1.5" OVERLAY

3) 1.5" MILL, OVERLAY & INSTALLATION OF PAVING FABRIC

4) 1.5" MILL & OVERLAY

5) 3" MILL AND OVERLAY WITH 25 MM SUPERPAVE & OVERLAY WITH 1.5" - 9.5 MM SUPERPAVE

*CONTRACTOR IN CHARGE OF ALL PURCHASE, TRANSPORT, AND INSTALLATION OF MATERIALS IN ACCORDANCE WITH PENNDOT PUB 408 SPECIFICATIONS

ESCALATOR CLAUSE:(if adopted by Municipality.)

NONE

THIS PORTION TO BE COMPLETED
BY THE MUNICIPALITY**SCHEDULE OF PRICES**

Item 1 No.	Approximate 2 Quantities	Unit 3	*Description 4	Unit 5 Price	Total 6
1	100	SY	Base Repair & Road Restoration, including excavation, removal of materials and transport, installation of 6" of 2A aggregate and installation of 3" - 25 mm SUPERPAVE to top of milled surface. (Complete in place)		
2	2,220	TON	Mill and Overlay, 3" Depth, including removal and transport of existing materials, tack coat and Installation of 3" - 25 mm SUPERPAVE. (Complete in place)		
3	733	SY	Mill Notch, 1.5" Depth, Varying Width, including removal of existing materials and transport. (Complete in place)		
4	1,115	TON	Clean Roadway Surface and Installation of 1.5" of 9.5 mm SUPERPAVE with pavement joint sealing over existing varying roadway width; +/- 20' wide. Pave with safety edges. (Complete in place)		
5	10,430	SY	Installation of PennDOT Approved Paving Fabric full length and width of roadway. (Complete in place)		

*** DESCRIPTION:**

Must include ADT on wearing surfaces
USE OF CUTBACK ASPHALT IS PROHIBITED
BETWEEN MAY 1st AND OCTOBER 31st, EXCEPT
AS NOTED IN BULLETIN NO. 25.
FOR OPTION OR PHASE BIDS THE TOTALS FOR
EACH MUST BE INCLUDED.

ALTERNATIVE NO. 5

SUBTOTAL	
SUBTOTAL FROM OTHER ATTACHMENTS	
BID TOTAL FOR A NON OPTION / PHASE BID	
OPTION 1 OR PHASE 1 BID TOTAL	
OPTION 2 OR PHASE 2 BID TOTAL	
OPTION 3 OR PHASE 3 BID TOTAL	

**SPECIAL PROVISIONS TO CONTRACT MS-944 (Attachment 1-A)
CONTAINS IMPORTANT INFORMATION FOR THE CONTRACTOR**

The Prime Contractor and subcontractors must comply with all of the following provisions that are marked with an "X".

Traffic Control and Safety Devices to be provided by the Contractor.

(Maintenance and Protection of Traffic to comply with current MUTCD, Publication 212 and Publication 213.)

- X Delivery tickets for all materials.
- X CS-4171 Certificate of Compliance and/ or CS-4171B Daily Asphalt Mixture Certification required for all materials.
- X Notify the Municipality five working days prior to start of project.
- X Work to be completed on or before 10/31/2025 . After 11/14/2025 Liquidated damages apply at the rate of \$ 885.00 per calendar day.
- X Roadway to be power broomed by (contractor ☒ municipality ☐)prior to start of project.
- X Excess material to be removed by (contractor ☒ municipality ☐ .)
- X Municipality to inspect project.
Need Bill of Lading for each shipment of asphalt material per Section 702.1(c) of Specifications 408.
- X Tack Coat required per Section 460, or 413 for superpave, of Specifications 408 and is incidental to paving item unless noted otherwise.
Prime Coat required per Section 461 of Specifications 408.
- X Asphalt Seal on all abutting pavement and curbs required.
- X Saw cut or Milled Paving Notch required and incidental to paving item unless noted otherwise.
- X Scratch/ Leveling Courses to be placed at the discretion of appointed inspector(s).
Full width pavement with one pass required. .
- X Municipality reserves the right to limit work completed.
Taper pavement the last 3 feet to curb.
For FOB Source bids, hauling distance will determine selection of bid award.
- X Municipality reserves the right to procure material which best suits their requirements after all bids and items are reviewed.
- X Incidental Preparation and clean up required. (Project Construction Materials)
- X The municipality reserves the right to make an award on the basis of the aggregate total for all like items on which quotations are received.
- X Provide design, which meets Specifications Form 408 to the municipality 5 days prior to start of work.
Contractor responsible for defects that occur within one year of applications.
Contractor required to review proposed project with Municipality's Representative prior to bidding.
Oil Samples required from each distributor truck by contractor (1) one quart : A.M. & P.M. and witnessed by municipality and retained by municipality. (Oil samples must be placed in an approved type container that is compatible with oil sample.)
At least three random stone samples to be taken by contractor on project site witnessed by municipality and retained by municipality.
Complete all testing in accordance with Specification Form 408 Section 413 except for superpave volumetric testing.
- X Notice to Proceed will be the date of Contract acceptance.
- X Final Completion Certificate & Notice of Completion required.
- X Future award of Contract will be based on quality of work as determined by the municipality.
Contractor, notify all residents of pending work to be performed.

My signature signifies that I have read and understand the above special provisions to this contract, and by being authorized by this company to act as their authorized representative, and on their behalf hereby agree to adhere to any and all of the provisions pertaining to this contract.

Contractor's Representative

Date

Company

Municipality's Representative

Date

WEST SADSBRURY TOWNSHIP

Municipality

PROPOSAL AND CONTRACT INSTRUCTIONS- FORM 944 (Rev. 4/2020)

- 1 The proposal must be typewritten or printed.
- 2 If more than one proposal on any project is submitted by an individual, firm or partnership, corporation or association under the same or different names, only one lowest proposal will be considered.
- 3 Description of Work- - -

A. If additional space is needed, insert appropriately numbered attachment and note "Continued on attached work sheets."
- 4 Part A of Page 1 to be completed by municipality. Part B of Page 1 to be completed by contractor. Schedule of Prices - Column #1 (Item), #2 (Approximate quantities), #3 (Unit, i.e., ton, square yard, linear feet, etc.) and #4 (Description, i.e., asphalt materials - 9.5 mm S & L, 12.5 mm Wearing, 25.0 mm Base Course, etc.) Must be filled in by the municipality to insure equitable bidding. Columns #5 (Unit Price), #6 (Total) and total amount of bid, must be filled in by the contractor. If more space is needed, add note at the bottom of the page; "Continued on Attachment No. 1-A", and add additional sheet designated as Attachment No. 1-A, 1-B, etc.. Repeat for each additional sheet required. As required by Publication 408, Section 102.06(e), each bidder must submit a completed Form 7126 - Anti-Collusion Affidavit with its bid proposal.
- 5 If liquidated damages are to be assessed, add the following sentence to Part A #2. If all work is not completed on time, liquidated damages will be assessed at the rate of \$885.00 per additional working day. (OR "... as set forth in the attached schedule.")
- 6 Payment and Performance bonds are provided only by the successful bidder. Contracts from \$4,000.00 up to \$5,000.00 in Second Class Townships - performance bond must be not less than 10% or greater than 100% of amount of contract. Contracts greater than \$1,500.00 up to \$10,000.00 in First Class Townships, Boroughs and Third Class Cities - bonds must be between 50 % to 100% of the contract amount. Contracts in excess of \$5,000.00 in Second Class Townships and in excess of \$10,000.00 in First Class Townships, Boroughs and Third Class Cities - bonds must be in 100% of the amount of the contract. Bond Forms MS-944 Attachments 2 and 3 and Workmen's Compensation Affidavit - Attachment 4 must be submitted by the successful bidder within 20 days of the contract award. Failure to submit the bonds shall constitute grounds to cancel the contract.
- 7 *Construction projects, where the estimated cost of the total project exceeds \$100,000, are subject to the provisions of the Pennsylvania Prevailing Wage Act 442 and amended by Act 89 of 2013. It is the responsibility of the municipality to request the Prevailing Wage Scale for the area and include it in the proposal. If the Prevailing Wage Act applies, this fact shall be noted in the advertisement.

On projects utilizing Federal Revenue Sharing Funds, if the project cost exceeds \$2,000 and is financed with 25% or more Federal Revenue Sharing Funds, the Davis Bacon Act applies. Again, it is the responsibility of the municipality to obtain the Davis Bacon Wage Rates, include them in the proposal and note the fact in the advertisement. If both acts are applicable, The Davis Bacon Act has preference over the Pennsylvania Prevailing Wage Act.
- 8 An ESCALATOR CLAUSE is optional; if used, it must be included in the proposal prepared by the municipality. An escalator clause may not be inserted by the contractor.

*(1961, Aug. 15, P.L. 987; 43 P.S. 165)

PERFORMANCE BOND (With Corporate Surety)



KNOW ALL MEN BY THESE PRESENTS, That we,

(NAME AND ADDRESS OF CONTRACTOR)

as Principal and _____
(SURETY COMPANY)

a corporation incorporated under the laws of the State of _____ as Surety
(NAME OF STATE)

are held and firmly bound unto _____ in the full and just sum of
(NAME OF MUNICIPALITY)

(\$ _____) dollars

lawful money to the United States of America, to be paid to the above Municipality or its assigns, to which payment well and truly to be made, we bind ourselves, our heirs, executors, administrators, successors and assigns, jointly and severally, firmly by these presents.

WHEREAS, the above bounden Principal has entered into a contract with the above Municipality, bearing even date herewith, for the undertaking of certain obligations as therein set forth.

NOW, THEREFORE, the condition of this obligation is such that if the above bounden Principal, as Contractor, shall in all respects comply with and faithfully perform the terms and conditions of said Contract, including the Specifications and conditions referred to and made a part thereof, and such alterations as may be made in said Specifications as therein provided, and shall well and truly, and in a manner satisfactory to the municipality fulfill all obligations as therein set forth, then this Obligation shall be void, but otherwise the same shall be and remain in full force, virtue and effect.

It is further provided that any alteration which may be made in the terms of the contractor or its specifications with the express approval of the Municipality or the Principal to the other, shall not in any way release the Principal and the Surety or either or any of them, their heirs, executors, administrators, successors or assigns from their liability hereunder, notice to the surety of any such alteration or forbearance being hereby waived.

IN WITNESS WHEREOF, the said Principal and Surety have duly executed this Bond under Seal, pursuant to due and legal action authorizing the same to be done on _____.

(DATE OF BOND)

PLACE
SEAL
HERE

Attest / Witness:

CONTRACTOR

BY

TITLE:

TITLE:

PLACE
SEAL
HERE

Attest / Witness:

SURETY COMPANY

TITLE:

TITLE:



KNOW ALL MEN BY THESE PRESENTS, that we

as PRINCIPAL and _____
 a corporation incorporated under the laws of the State of _____ as SURETY, are
 held and firmly bond unto the _____, in the full and just sum of
 _____ (\$ _____) dollars, lawful money of the
 United States of America, to be paid to the said _____ or its assigns, to which
 payment well and truly to be made, we bind ourselves, our heirs, executors, administrators,
 successors and assigns, jointly and severally, firmly by these presents.

WHEREAS, the above bounden Principal has entered into a contract with the above
 municipality hereinafter called Obligee, bearing even date herewith, for the improvement of a
 certain section of highway or bridge in said Municipality consisting of:

_____ for approximately the sum of: _____ (\$ _____) dollars.

NOW, THEREFORE, the condition of this obligation is such that if the above bounden
 PRINCIPAL shall and will promptly pay or cause to be paid in full all sums of money which may be
 due by contract or otherwise, to any individual, firm, partnership, association or corporation, for all
 material furnished or labor supplied or performed in the prosecution of the work, whether or not the
 said for material or labor entered into and became component parts of the work and for rental of the
 equipment used and services rendered by public utilities in, or in connection with the prosecution of
 such work, then this obligation to be void, otherwise to remain in full force and effect.

The **PRINCIPAL** and **SURETY**, hereby, jointly and severally, agree with the Obligee herein
 that any individual firm, partnership, association or corporation, which has performed labor or
 furnished material in the prosecution of the work as provided, and any public utility which has not
 been paid in full therefor, may sue in assumpsit on this Payment Bond in his, their, or its own name
 and may prosecute the same to final for such sum or sums as may be justly due him, them or it, and
 have execution thereon. Provided, however, that the Obligee shall not be liable for the payment of
 any costs of expenses of such suit.

RECOVERY by any individual, firm, partnership, association or corporation hereunder shall
 be subject to the provisions of the "Public Works Contractors' Bond Law of 1967", Act No. 385,
 approved December 20, 1967, P.L. 869, which Act shall be incorporated herein and made a part
 hereof, as fully and completely as though its provisions were fully and at length herein recited.

It is further provided that any alterations which may be made in the terms of the contract or
 in the work to be done or materials to be furnished or labor to be supplied or performed under it or
 the giving by the Obligee of any extension of time for the performance of the contract or any other
 forbearance on the part of either the Obligee or the Principal to the other, shall not in any way
 release the PRINCIPAL and the SURETY or SURETIES of any such alteration, extension of
 forbearance being hereby waived.

IN WITNESS WHEREOF, the said PRINCIPAL and SURETY have duly executed this Bond
 under seal this _____ day of _____, 20 ____.



WITNESS:

 CONTRACTOR

 TITLE:

BY:

 TITLE:



WITNESS:

 SURETY COMPANY

 TITLE:

 TITLE:



AFFIDAVIT RE

ACCEPTING PROVISIONS OF THE WORKMEN'S COMPENSATION ACT

State of

)

)

) ss:

)

County of

)

being duly sworn according to law deposes and says that they ^{he has} have
it has

accepted the provisions of the Workmen's Compensation Act of 1915 of the Commonwealth of Pennsylvania, with

^{has} ^{his}
its supplements and amendments, and have insured their liability thereunder in accordance with the terms of said
its

Act with

(SURETY COMPANY)

(TYPE OR PRINT)

CONTRACTOR

BY

SIGNATURE

Sworn to and subscribed before me this ____ day of _____ A.D. 20 ____ .

SIGNATURE

My Commission Expires

(DATE)

ANTI-COLLUSION AFFIDAVIT



State of _____

County of _____

County CHESTER

Municipality WEST SADBURY TOWNSHIP

Project Number _____

Fed. Project No. _____
(If Applicable)

The undersigned deponent deposes and says that he is the _____
of the _____ Company; that he is authorized to make this
affidavit on behalf of said company in compliance with section 102.06 (e) of Department Specifications,
Publication 408, as amended and that the said company has not, either directly or indirectly, entered
into any agreement, participated in any collusion, or otherwise taken any action in restraint of free
competitive bidding in connection with such contract.

(Contractor)

BY

Sworn to and subscribed before me the undersigned notary public this

_____ day of _____, _____.

Notary Public

My Commission expires _____

LEGEND

- LIMITED ACCESS HIGHWAY
- 0944

STATE ROUTE AND NUMBER
- 3019

STATE MAINTAINED BRIDGE
ON TOWNSHIP ROAD
- T715

.34

TOWNSHIP ROAD, NUMBER AND
SEGMENT LENGTH IN MILES
- IMPASSABLE TOWNSHIP ROAD
- TURNBACK TOWNSHIP ROAD
- OTHER ROAD
- RAILROAD (IN SERVICE)
- RAILROAD ABANDONED
(TRACK RETAINED)
- STATE BOUNDARY
- COUNTY BOUNDARY
- TOWNSHIP BOUNDARY
- CITY OR BOROUGH BOUNDARY
- MUNICIPAL BUILDING
- .70

2

SPLIT MILEAGE BETWEEN
MUNICIPALITIES

POPULATION 2,436
(2020 Census)

- 334 NO NAME
- 338 MT VERNON RD
- 342 BLACKHORSE RD
- 346 LENOVER HILL RD
- 348 LIMESTONE RD
- 379 CHURCH RD
- 391 LEIKE RD
- 407 LIMEVILLE RD
- 413 QUARRY RD
- 414 CREEK RD
- 415 HARRY RD
- 416 CEMETERY RD
- 417 ZIONHILL RD
- 418 NEWLIN RD
- 419 HURLEY RD
- 420 S LENOVER RD
- 421 ZOOK RD
- 422 MOSCOW RD
- 572 LIMESTONE RD
- 573 CYGNET DR
- 574 WALNUT DR
- 575 BUTTERNUT DR
- 576 WOODLAND DR
- 577 AMY DR
- 578 RABBIT RUN RD
- 579 UPPER VALLEY RD
- 580 SWAN RD

TOTAL MILES	
Township Road System	22.44*
State Highway System	5.86
Total	28.30

* Includes ACT 32 Turnback Mileage of 4.37

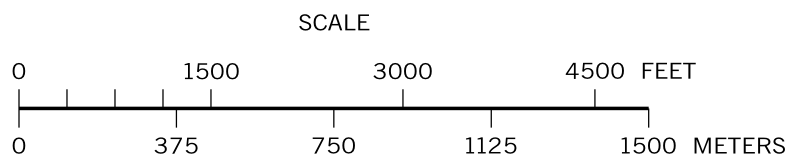
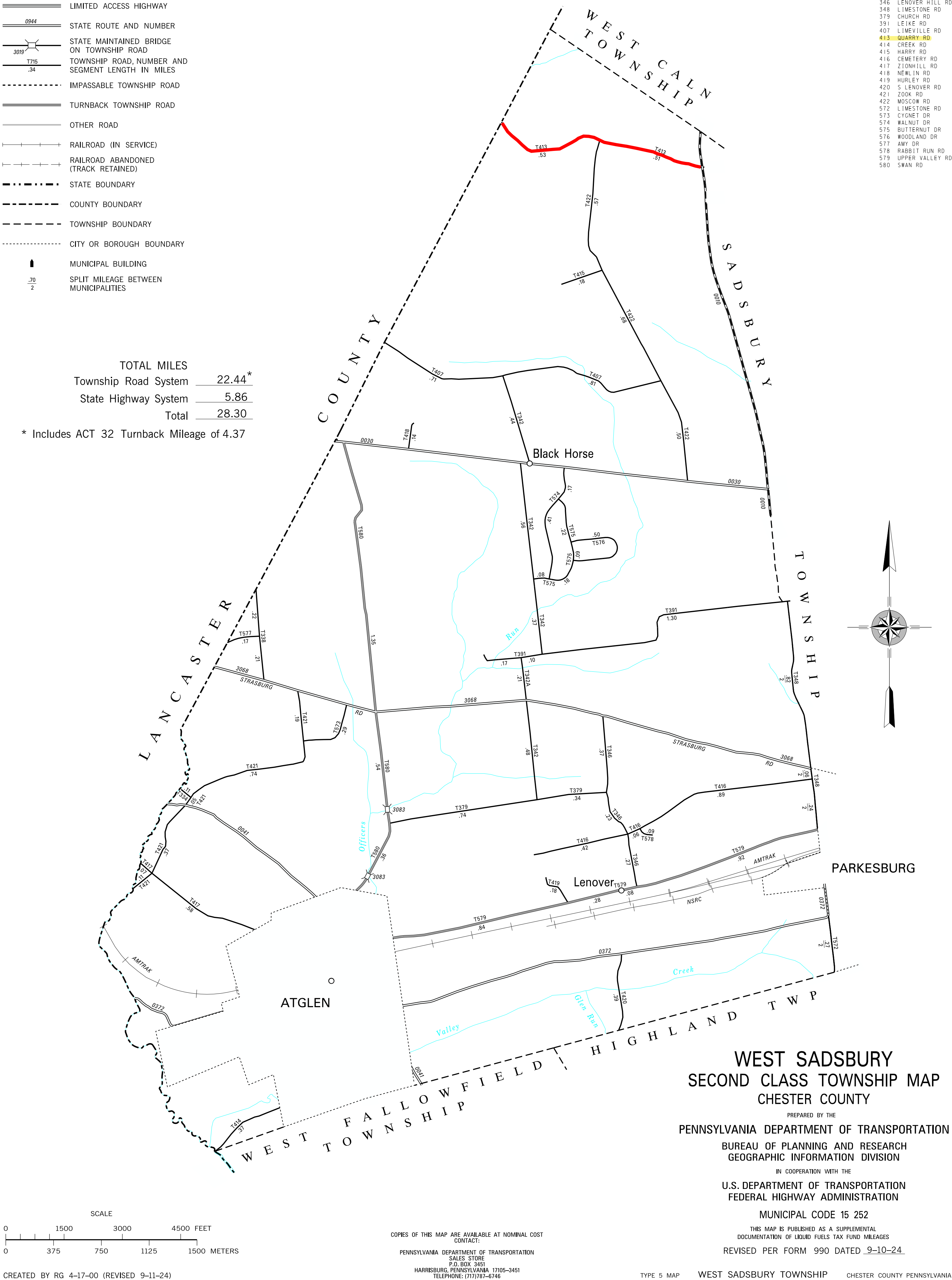

COPIES OF THIS MAP ARE AVAILABLE AT NOMINAL COST
CONTACT:
PENNSYLVANIA DEPARTMENT OF TRANSPORTATION
SALES STORE
P.O. BOX 3451
HARRISBURG, PENNSYLVANIA 17105-3451
TELEPHONE: (717)787-6746

**BUREAU OF LABOR LAW COMPLIANCE
PREVAILING WAGES PROJECT RATES**

Project Name:	Quarry Road
General Description:	Asphalt paving and restoration efforts on Quarry Road
Project Locality	West Sadsbury Township - Quarr
Awarding Agency:	West Sadsbury Township
Contract Award Date:	9/9/2025
Serial Number:	25-07991
Project Classification:	Highway
Determination Date:	8/18/2025
Assigned Field Office:	Philadelphia
Field Office Phone Number:	(215)560-1858
Toll Free Phone Number:	
Project County:	Chester County

BUREAU OF LABOR LAW COMPLIANCE PREVAILING WAGES PROJECT RATES

Project: 25-07991 - Building	Effective Date	Expiration Date	Hourly Rate	Fringe Benefits	Total
Asbestos & Insulation Workers	5/1/2024		\$59.37	\$46.03	\$105.40
Asbestos & Insulation Workers	5/1/2025		\$60.84	\$48.71	\$109.55
Boilermakers	3/1/2018		\$45.89	\$33.73	\$79.62
Bricklayer	5/1/2023		\$47.50	\$31.42	\$78.92
Bricklayer	5/1/2025		\$50.00	\$32.57	\$82.57
Carpenter - Chief of Party (Surveying & Layout)	5/1/2024		\$52.58	\$29.02	\$81.60
Carpenter - Chief of Party (Surveying & Layout)	5/1/2025		\$54.59	\$29.02	\$83.61
Carpenter - Instrument Person (Surveying & Layout)	5/1/2024		\$45.72	\$29.02	\$74.74
Carpenter - Instrument Person (Surveying & Layout)	5/1/2025		\$47.47	\$29.02	\$76.49
Carpenter - Rodman (Surveying & Layout)	5/1/2024		\$22.86	\$20.62	\$43.48
Carpenter - Rodman (Surveying & Layout)	5/1/2025		\$23.74	\$20.62	\$44.36
Carpenters	5/1/2024		\$45.72	\$29.02	\$74.74
Carpenters	5/1/2025		\$47.47	\$29.02	\$76.49
Cement Finishers & Plasterers	5/1/2022		\$38.57	\$32.39	\$70.96
Cement Masons	5/1/2024		\$46.70	\$32.46	\$79.16
Cement Masons	5/1/2025		\$48.70	\$32.46	\$81.16
Dockbuilder, Pile Drivers	5/1/2024		\$52.98	\$37.99	\$90.97
Dockbuilder, Pile Drivers	5/1/2025		\$55.23	\$37.99	\$93.22
Dockbuilder, Pile Drivers	5/1/2026		\$56.98	\$37.99	\$94.97
Dockbuilder/Pile Driver Diver	5/1/2024		\$61.54	\$41.74	\$103.28
Dockbuilder/Pile Driver Diver	5/1/2025		\$64.35	\$41.74	\$106.09
Dockbuilder/Pile Driver Diver	5/1/2026		\$66.54	\$41.74	\$108.28
Dockbuilder/pile driver tender	5/1/2024		\$52.98	\$37.99	\$90.97
Dockbuilder/pile driver tender	5/1/2025		\$55.23	\$37.99	\$93.22
Dockbuilder/pile driver tender	5/1/2026		\$56.98	\$37.99	\$94.97
Drywall Finisher	5/1/2024		\$42.25	\$32.56	\$74.81
Drywall Finisher	5/1/2025		\$43.78	\$33.00	\$76.78
Electricians	6/3/2024		\$50.17	\$38.87	\$89.04
Electricians	6/2/2025		\$52.71	\$40.07	\$92.78
Electricians	6/1/2026		\$55.25	\$41.28	\$96.53
Elevator Constructor	1/1/2024		\$68.97	\$44.70	\$113.67
Elevator Constructor	1/1/2025		\$71.85	\$45.77	\$117.62
Floor Coverer	5/1/2024		\$52.19	\$29.21	\$81.40
Floor Coverer	5/1/2025		\$51.67	\$31.69	\$83.36
Floor Coverer	5/1/2026		\$52.84	\$32.86	\$85.70
Glazier	5/1/2024		\$48.00	\$37.50	\$85.50
Glazier	5/1/2025		\$49.96	\$38.34	\$88.30
Interior Finish	5/1/2023		\$34.60	\$25.80	\$60.40
Iron Workers (Bridge, Structural, Ornamental, Precast)	7/1/2024		\$53.20	\$45.01	\$98.21
Iron Workers (Riggers)	7/1/2024		\$44.64	\$34.39	\$79.03
Iron Workers (Riggers)	7/1/2025		\$44.77	\$36.27	\$81.04
Iron Workers (Rodman/Reinforcing)	7/1/2024		\$47.70	\$34.77	\$82.47
Iron Workers (Rodman/Reinforcing)	7/1/2025		\$47.80	\$36.65	\$84.45
Laborers (Class 01 - See notes)	5/1/2024		\$35.85	\$26.00	\$61.85

BUREAU OF LABOR LAW COMPLIANCE PREVAILING WAGES PROJECT RATES

Project: 25-07991 - Building	Effective Date	Expiration Date	Hourly Rate	Fringe Benefits	Total
Laborers (Class 01 - See notes)	5/1/2025		\$37.25	\$26.10	\$63.35
Laborers (Class 02 - See notes)	5/1/2024		\$39.40	\$27.55	\$66.95
Laborers (Class 02 - See notes)	5/1/2025		\$41.00	\$27.70	\$68.70
Laborers (Class 03 - See notes)	5/1/2024		\$36.27	\$26.18	\$62.45
Laborers (Class 03 - See notes)	5/1/2025		\$37.67	\$26.28	\$63.95
Laborers (Class 04 - See notes)	5/1/2024		\$36.27	\$26.18	\$62.45
Laborers (Class 04 - See notes)	5/1/2025		\$37.67	\$26.28	\$63.95
Laborers (Class 05 - See notes)	5/1/2024		\$35.85	\$26.00	\$61.85
Laborers (Class 05 - See notes)	5/1/2025		\$37.25	\$26.10	\$63.35
Landscape Laborer	5/1/2024		\$30.70	\$24.23	\$54.93
Landscape Laborer	5/1/2025		\$32.15	\$24.30	\$56.45
Marble Finisher	5/1/2025		\$41.17	\$30.75	\$71.92
Marble Mason	5/1/2023		\$47.20	\$31.95	\$79.15
Mason Tender, Cement	5/1/2023		\$35.02	\$25.98	\$61.00
Millwright	5/1/2024		\$54.67	\$35.81	\$90.48
Millwright	5/1/2025		\$57.39	\$35.81	\$93.20
Millwright	5/1/2026		\$60.20	\$35.81	\$96.01
Operators (Building, Class 01 - See Notes)	5/1/2023		\$52.20	\$32.81	\$85.01
Operators (Building, Class 01 - See Notes)	5/1/2024		\$53.36	\$33.65	\$87.01
Operators (Building, Class 01 - See Notes)	5/1/2025		\$54.52	\$34.49	\$89.01
Operators (Building, Class 01 - See Notes)	5/1/2026		\$55.67	\$35.34	\$91.01
Operators (Building, Class 01A - See Notes)	5/1/2023		\$55.20	\$33.70	\$88.90
Operators (Building, Class 01A - See Notes)	5/1/2024		\$56.37	\$34.53	\$90.90
Operators (Building, Class 01A - See Notes)	5/1/2025		\$57.52	\$35.38	\$92.90
Operators (Building, Class 01A - See Notes)	5/1/2026		\$58.68	\$36.22	\$94.90
Operators (Building, Class 02 - See Notes)	5/1/2023		\$51.95	\$32.74	\$84.69
Operators (Building, Class 02 - See Notes)	5/1/2024		\$53.11	\$33.58	\$86.69
Operators (Building, Class 02 - See Notes)	5/1/2025		\$54.27	\$34.42	\$88.69
Operators (Building, Class 02 - See Notes)	5/1/2026		\$55.43	\$35.26	\$90.69
Operators (Building, Class 02A - See Notes)	5/1/2023		\$54.97	\$33.61	\$88.58
Operators (Building, Class 02A - See Notes)	5/1/2024		\$56.13	\$34.45	\$90.58
Operators (Building, Class 02A - See Notes)	5/1/2025		\$57.29	\$35.29	\$92.58
Operators (Building, Class 02A - See Notes)	5/1/2026		\$58.44	\$36.14	\$94.58
Operators (Building, Class 03 - See Notes)	5/1/2023		\$47.87	\$31.53	\$79.40
Operators (Building, Class 03 - See Notes)	5/1/2024		\$49.03	\$32.37	\$81.40
Operators (Building, Class 03 - See Notes)	5/1/2025		\$50.18	\$33.22	\$83.40
Operators (Building, Class 03 - See Notes)	5/1/2026		\$51.34	\$34.06	\$85.40
Operators (Building, Class 04 - See Notes)	5/1/2023		\$47.57	\$31.44	\$79.01
Operators (Building, Class 04 - See Notes)	5/1/2024		\$48.73	\$32.28	\$81.01
Operators (Building, Class 04 - See Notes)	5/1/2025		\$49.88	\$33.13	\$83.01
Operators (Building, Class 04 - See Notes)	5/1/2026		\$51.04	\$33.97	\$85.01
Operators (Building, Class 05 - See Notes)	5/1/2023		\$45.85	\$30.93	\$76.78
Operators (Building, Class 05 - See Notes)	5/1/2024		\$47.00	\$31.78	\$78.78
Operators (Building, Class 05 - See Notes)	5/1/2025		\$48.16	\$32.62	\$80.78

BUREAU OF LABOR LAW COMPLIANCE PREVAILING WAGES PROJECT RATES

Project: 25-07991 - Building	Effective Date	Expiration Date	Hourly Rate	Fringe Benefits	Total
Operators (Building, Class 05 - See Notes)	5/1/2026		\$49.32	\$33.46	\$82.78
Operators (Building, Class 06 - See Notes)	5/1/2023		\$44.85	\$30.65	\$75.50
Operators (Building, Class 06 - See Notes)	5/1/2024		\$46.02	\$31.48	\$77.50
Operators (Building, Class 06 - See Notes)	5/1/2025		\$47.17	\$32.33	\$79.50
Operators (Building, Class 06 - See Notes)	5/1/2026		\$48.34	\$33.16	\$81.50
Operators (Building, Class 07A- See Notes)	5/1/2023		\$63.33	\$37.68	\$101.01
Operators (Building, Class 07A- See Notes)	5/1/2024		\$64.80	\$38.61	\$103.41
Operators (Building, Class 07A- See Notes)	5/1/2025		\$66.26	\$39.55	\$105.81
Operators (Building, Class 07A- See Notes)	5/1/2026		\$67.73	\$40.48	\$108.21
Operators (Building, Class 07B- See Notes)	5/1/2023		\$63.04	\$37.59	\$100.63
Operators (Building, Class 07B- See Notes)	5/1/2024		\$64.50	\$38.53	\$103.03
Operators (Building, Class 07B- See Notes)	5/1/2025		\$65.97	\$39.46	\$105.43
Operators (Building, Class 07B- See Notes)	5/1/2026		\$67.44	\$40.39	\$107.83
Painters Class 1 (see notes)	5/1/2024		\$42.97	\$34.11	\$77.08
Painters Class 1 (see notes)	5/1/2025		\$44.38	\$34.55	\$78.93
Painters - Line Stripping	12/1/2024		\$44.12	\$27.91	\$72.03
Painters Class 4 (see notes)	5/1/2024		\$45.06	\$34.11	\$79.17
Painters Class 4 (see notes)	5/1/2025		\$46.47	\$34.55	\$81.02
Plasterers	5/1/2023		\$39.32	\$32.64	\$71.96
Plasterers	5/1/2024		\$39.88	\$33.08	\$72.96
plumber	5/1/2024		\$67.53	\$38.31	\$105.84
plumber	5/1/2025		\$70.53	\$39.46	\$109.99
Pointers, Caulkers, Cleaners	5/1/2023		\$48.80	\$30.70	\$79.50
Pointers, Caulkers, Cleaners	5/1/2025		\$51.35	\$31.80	\$83.15
Roofers (Composition)	5/1/2024		\$44.13	\$34.77	\$78.90
Roofers (Composition)	5/1/2025		\$46.03	\$34.77	\$80.80
Roofers (Shingle)	5/1/2023		\$32.85	\$22.10	\$54.95
Roofers (Shingle)	5/1/2024		\$34.35	\$22.20	\$56.55
Roofers (Slate & Tile)	5/1/2023		\$35.85	\$22.10	\$57.95
Roofers (Slate & Tile)	5/1/2024		\$37.35	\$22.20	\$59.55
Sheet Metal Workers	5/1/2024		\$59.22	\$50.56	\$109.78
Sheet Metal Workers	5/1/2025		\$62.62	\$52.17	\$114.79
Sign Makers and Hangars	7/15/2024		\$32.32	\$25.82	\$58.14
Sign Makers and Hangars	7/15/2025		\$33.48	\$26.41	\$59.89
Sprinklerfitters	1/1/2023		\$62.23	\$31.99	\$94.22
Sprinklerfitters	5/1/2025		\$70.37	\$34.85	\$105.22
Steamfitters	5/1/2024		\$70.32	\$43.09	\$113.41
Steamfitters	5/1/2025		\$72.52	\$44.89	\$117.41
Stone Masons	5/1/2023		\$47.20	\$31.95	\$79.15
Terrazzo Finisher	5/1/2023		\$43.75	\$27.86	\$71.61
Terrazzo Finisher	5/1/2025		\$45.61	\$29.41	\$75.02
Terrazzo Grinder	5/1/2023		\$44.02	\$27.86	\$71.88
Terrazzo Grinder	5/1/2025		\$45.88	\$29.41	\$75.29
Terrazzo Mechanics	5/1/2023		\$50.26	\$29.56	\$79.82

**BUREAU OF LABOR LAW COMPLIANCE
PREVAILING WAGES PROJECT RATES**

Project: 25-07991 - Building	Effective Date	Expiration Date	Hourly Rate	Fringe Benefits	Total
Terrazzo Mechanics	5/1/2025		\$52.21	\$31.26	\$83.47
Tile Finisher	5/1/2023		\$39.52	\$29.30	\$68.82
Tile Finisher	5/1/2025		\$41.17	\$30.75	\$71.92
Tile Setter	5/1/2023		\$50.26	\$29.56	\$79.82
Tile Setter	5/1/2025		\$52.21	\$31.26	\$83.47
Truckdriver class 1(see notes)	5/1/2024		\$36.79	\$22.54	\$59.33
Truckdriver class 2 (see notes)	5/1/2024		\$36.89	\$22.54	\$59.43
Window Film / Tint Installer	6/1/2019		\$24.52	\$12.08	\$36.60

BUREAU OF LABOR LAW COMPLIANCE PREVAILING WAGES PROJECT RATES

Project: 25-07991 - Heavy/Highway	Effective Date	Expiration Date	Hourly Rate	Fringe Benefits	Total
Bricklayer	5/1/2025		\$50.00	\$32.57	\$82.57
Carpenter - Chief of Party (Surveying & Layout)	5/1/2024		\$65.19	\$29.06	\$94.25
Carpenter - Chief of Party (Surveying & Layout)	5/1/2025		\$65.96	\$30.09	\$96.05
Carpenter - Chief of Party (Surveying & Layout)	5/1/2026		\$67.52	\$30.44	\$97.96
Carpenter - Instrument Person (Surveying & Layout)	5/1/2024		\$56.69	\$29.06	\$85.75
Carpenter - Instrument Person (Surveying & Layout)	5/1/2025		\$58.39	\$29.06	\$87.45
Carpenter - Instrument Person (Surveying & Layout)	5/1/2026		\$60.09	\$29.06	\$89.15
Carpenter - Rodman (Surveying & Layout)	5/1/2024		\$45.35	\$22.41	\$67.76
Carpenter - Rodman (Surveying & Layout)	5/1/2025		\$45.88	\$23.19	\$69.07
Carpenter - Rodman (Surveying & Layout)	5/1/2026		\$46.97	\$23.54	\$70.51
Carpenter	5/1/2024		\$56.69	\$29.06	\$85.75
Carpenter	5/1/2025		\$57.36	\$30.09	\$87.45
Carpenter	5/1/2026		\$58.71	\$30.44	\$89.15
Cement Masons	5/1/2023		\$43.20	\$32.91	\$76.11
Cement Masons	5/1/2025		\$46.55	\$32.66	\$79.21
Dockbuilder, Pile Drivers	5/1/2024		\$52.98	\$37.99	\$90.97
Dockbuilder, Pile Drivers	5/1/2025		\$55.23	\$37.99	\$93.22
Dockbuilder, Pile Drivers	5/1/2026		\$56.98	\$37.99	\$94.97
Dockbuilder/Pile Driver Diver	5/1/2024		\$61.54	\$41.74	\$103.28
Dockbuilder/Pile Driver Diver	5/1/2025		\$60.31	\$44.97	\$105.28
Dockbuilder/Pile Driver Diver	5/1/2026		\$61.88	\$45.47	\$107.35
Dockbuilder/pile driver tender	5/1/2024		\$52.98	\$37.99	\$90.97
Dockbuilder/pile driver tender	5/1/2025		\$55.23	\$37.99	\$93.22
Dockbuilder/pile driver tender	5/1/2026		\$56.98	\$37.99	\$94.97
Electric Lineman	6/3/2024		\$62.07	\$33.96	\$96.03
Iron Workers (Bridge, Structural, Ornamental, Precast)	7/1/2024		\$53.20	\$45.01	\$98.21
Iron Workers (Riggers)	7/1/2023		\$42.53	\$34.14	\$76.67
Iron Workers (Rodman/Reinforcing)	7/1/2023		\$45.70	\$34.77	\$80.47
Laborers (Class 01 - See notes)	5/1/2024		\$38.80	\$27.65	\$66.45
Laborers (Class 01 - See notes)	5/1/2025		\$40.20	\$27.80	\$68.00
Laborers (Class 02 - See notes)	5/1/2024		\$39.00	\$27.65	\$66.65
Laborers (Class 02 - See notes)	5/1/2025		\$40.40	\$27.80	\$68.20
Laborers (Class 03 - See notes)	5/1/2024		\$39.00	\$27.65	\$66.65
Laborers (Class 03 - See notes)	5/1/2025		\$40.40	\$27.80	\$68.20
Laborers (Class 04 - See notes)	5/1/2024		\$33.60	\$27.65	\$61.25
Laborers (Class 04 - See notes)	5/1/2025		\$35.00	\$27.80	\$62.80
Laborers (Class 05 - See notes)	5/1/2024		\$39.65	\$27.65	\$67.30
Laborers (Class 05 - See notes)	5/1/2025		\$41.05	\$27.80	\$68.85
Laborers (Class 06 - See notes)	5/1/2024		\$39.70	\$27.65	\$67.35
Laborers (Class 06 - See notes)	5/1/2025		\$41.10	\$27.80	\$68.90
Laborers (Class 07 - See notes)	5/1/2024		\$39.55	\$27.65	\$67.20
Laborers (Class 07 - See notes)	5/1/2025		\$40.95	\$27.80	\$68.75
Laborers (Class 08 - See notes)	5/1/2024		\$39.30	\$27.65	\$66.95
Laborers (Class 08 - See notes)	5/1/2025		\$40.70	\$27.80	\$68.50

BUREAU OF LABOR LAW COMPLIANCE PREVAILING WAGES PROJECT RATES

Project: 25-07991 - Heavy/Highway	Effective Date	Expiration Date	Hourly Rate	Fringe Benefits	Total
Laborers (Class 09 - See notes)	5/1/2024		\$39.15	\$27.65	\$66.80
Laborers (Class 09 - See notes)	5/1/2025		\$40.55	\$27.80	\$68.35
Laborers (Class 10- See notes)	5/1/2024		\$39.30	\$27.65	\$66.95
Laborers (Class 10- See notes)	5/1/2025		\$40.70	\$27.80	\$68.50
Laborers (Class 11 -See Notes)	5/1/2024		\$39.20	\$27.65	\$66.85
Laborers (Class 11 -See Notes)	5/1/2025		\$40.60	\$27.80	\$68.40
Laborers (Class 12 -See Notes)	5/1/2024		\$40.90	\$27.65	\$68.55
Laborers (Class 12 -See Notes)	5/1/2025		\$42.30	\$27.80	\$70.10
Laborers (Class 13 -See Notes)	5/1/2024		\$42.93	\$27.65	\$70.58
Laborers (Class 13 -See Notes)	5/1/2025		\$44.33	\$27.80	\$72.13
Laborers (Class 14 -See Notes)	5/1/2024		\$39.50	\$27.65	\$67.15
Laborers (Class 14 -See Notes)	5/1/2025		\$40.90	\$27.80	\$68.70
Laborers Utility (PGW ONLY) (Flagperson)	5/1/2024		\$32.67	\$19.63	\$52.30
Laborers Utility (PGW ONLY) (Flagperson)	5/1/2025		\$34.07	\$19.73	\$53.80
Laborers Utility (PGW ONLY)	5/1/2024		\$39.70	\$19.63	\$59.33
Laborers Utility (PGW ONLY)	5/1/2025		\$41.10	\$19.73	\$60.83
Landscape Laborer	5/1/2024		\$30.28	\$24.05	\$54.33
Landscape Laborer	5/1/2025		\$31.73	\$24.15	\$55.88
Millwright	5/1/2024		\$54.67	\$35.81	\$90.48
Millwright	5/1/2025		\$57.39	\$35.81	\$93.20
Millwright	5/1/2026		\$60.20	\$35.81	\$96.01
Operators Class 01 - See Notes (Building, Heavy, Highway)	5/1/2024		\$53.36	\$33.65	\$87.01
Operators Class 01 - See Notes (Building, Heavy, Highway)	5/1/2025		\$54.52	\$34.49	\$89.01
Operators Class 01 - See Notes (Building, Heavy, Highway)	5/1/2026		\$55.67	\$35.34	\$91.01
Operators Class 01a - See Notes (Building, Heavy, Highway)	5/1/2024		\$56.37	\$34.53	\$90.90
Operators Class 01a - See Notes (Building, Heavy, Highway)	5/1/2025		\$57.52	\$35.38	\$92.90
Operators Class 01a - See Notes (Building, Heavy, Highway)	5/1/2026		\$58.68	\$36.22	\$94.90
Operators Class 02 - See Notes (Building, Heavy, Highway)	5/1/2024		\$53.11	\$33.58	\$86.69
Operators Class 02 - See Notes (Building, Heavy, Highway)	5/1/2025		\$54.27	\$34.42	\$88.69
Operators Class 02 - See Notes (Building, Heavy, Highway)	5/1/2026		\$55.43	\$35.26	\$90.69
Operators Class 02a - See Notes (Building, Heavy, Highway)	5/1/2024		\$56.13	\$34.45	\$90.58
Operators Class 02a - See Notes (Building, Heavy, Highway)	5/1/2025		\$57.29	\$35.29	\$92.58
Operators Class 02a - See Notes (Building, Heavy, Highway)	5/1/2026		\$58.44	\$36.14	\$94.58
Operators Class 03 - See Notes (Building, Heavy, Highway)	5/1/2024		\$49.03	\$32.37	\$81.40
Operators Class 03 - See Notes (Building, Heavy, Highway)	5/1/2025		\$50.18	\$33.22	\$83.40

BUREAU OF LABOR LAW COMPLIANCE PREVAILING WAGES PROJECT RATES

Project: 25-07991 - Heavy/Highway	Effective Date	Expiration Date	Hourly Rate	Fringe Benefits	Total
Operators Class 03 - See Notes (Building, Heavy, Highway)	5/1/2026		\$51.34	\$34.06	\$85.40
Operators Class 04 - See Notes (Building, Heavy, Highway)	5/1/2024		\$48.73	\$32.28	\$81.01
Operators Class 04 - See Notes (Building, Heavy, Highway)	5/1/2025		\$49.88	\$33.13	\$83.01
Operators Class 04 - See Notes (Building, Heavy, Highway)	5/1/2026		\$51.04	\$33.97	\$85.01
Operators Class 05 - See Notes (Building, Heavy, Highway)	5/1/2024		\$47.00	\$31.78	\$78.78
Operators Class 05 - See Notes (Building, Heavy, Highway)	5/1/2025		\$48.16	\$32.62	\$80.78
Operators Class 05 - See Notes (Building, Heavy, Highway)	5/1/2026		\$49.32	\$33.46	\$82.78
Operators Class 06 - See Notes (Building, Heavy, Highway)	5/1/2024		\$46.02	\$31.48	\$77.50
Operators Class 06 - See Notes (Building, Heavy, Highway)	5/1/2025		\$47.17	\$32.33	\$79.50
Operators Class 06 - See Notes (Building, Heavy, Highway)	5/1/2026		\$48.34	\$33.16	\$81.50
Operators Class 07 (A) - See Notes (Building, Heavy, Highway)	5/1/2024		\$64.80	\$38.61	\$103.41
Operators Class 07 (A) - See Notes (Building, Heavy, Highway)	5/1/2025		\$66.26	\$39.55	\$105.81
Operators Class 07 (A) - See Notes (Building, Heavy, Highway)	5/1/2026		\$67.73	\$40.48	\$108.21
Operators Class 07 (B) - See Notes (Building, Heavy, Highway)	5/1/2024		\$64.50	\$38.53	\$103.03
Operators Class 07 (B) - See Notes (Building, Heavy, Highway)	5/1/2025		\$65.97	\$39.46	\$105.43
Operators Class 07 (B) - See Notes (Building, Heavy, Highway)	5/1/2026		\$67.44	\$40.39	\$107.83
Painters - Line Stripping	12/1/2024		\$44.12	\$27.91	\$72.03
Painters Class 2 (see notes)	2/1/2024		\$49.57	\$33.34	\$82.91
Painters Class 2 (see notes)	2/1/2025		\$50.85	\$33.91	\$84.76
Painters Class 3 (see notes)	2/1/2024		\$60.53	\$33.38	\$93.91
Painters Class 3 (see notes)	2/1/2025		\$61.81	\$33.95	\$95.76
Pointers, Caulkers, Cleaners	5/1/2025		\$51.35	\$31.80	\$83.15
Steamfitters (Heavy and Highway - Gas Distribution)	5/1/2024		\$66.80	\$42.93	\$109.73
Steamfitters (Heavy and Highway - Gas Distribution)	5/1/2025		\$68.89	\$44.73	\$113.62
Steamfitters	5/1/2018		\$56.37	\$34.39	\$90.76
Truckdriver class 1(see notes)	5/1/2024		\$36.64	\$22.54	\$59.18
Truckdriver class 2 (see notes)	5/1/2024		\$36.74	\$22.54	\$59.28



COMMONWEALTH OF PENNSYLVANIA

PUBLIC WORKS EMPLOYMENT VERIFICATION FORM

Date _____

Business or Organization Name
(Employer) _____

Address _____

City _____ State _____ Zip Code _____

☐ Contractor ☐ Subcontractor (check one)

Contracting Public Body

Contract/Project No

Project Description

Project Location

As a contractor/subcontractor for the above referenced public works contract, I hereby affirm that as of the above date, our company is in compliance with the Public Works Employment Verification Act ('the Act') through utilization of the federal E-Verify Program (EVP) operated by the United States Department of Homeland Security. To the best of my/our knowledge, all employees hired post January 1, 2013 are authorized to work in the United States.

It is also agreed to that all public works contractors/subcontractors will utilize the federal EVP to verify the employment eligibility of each new hire within five (5) business days of the employee start date throughout the duration of the public works contract. Documentation confirming the use of the federal EVP upon each new hire shall be maintained in the event of an investigation or audit.

I, _____, authorized representative of the company above, attest that the information contained in this verification form is true and correct and understand that the submission of false or misleading information in connection with the above verification shall be subject to sanctions provided by law.

Authorized Representative Signature